

OFFICIAL DESCRIPTION CHANGE

OFFICE: Transportation Data

ENTERED BY: Stefani Wonders

ENTERED DATE: 09-18-2006

DISCUSSION/BACKGROUND:

Due to a review of our Primary System records, the primary route description for Interstate 29 in Monona County was revised.

PROPOSAL/ACTION RECOMMENDATION:

New Description – Interstate 29 and its extensions in Monona County described as follows:

Beginning on the Monona–Harrison County line near the S $\frac{1}{4}$ Corner of the SE $\frac{1}{4}$ Section 32–T82N–R45W, Monona County (N $\frac{1}{4}$ Corner of the NE $\frac{1}{4}$ Section 5–T81N–R45W, Harrison County); thence in a northerly direction through Sections 32, 29, 20, 17, 8, and 5–T82N–R45W and Section 32–T83N–R45W approximately 1317 feet west of the NE Corner of said Section 32; thence in a northerly and northwesterly direction through Sections 29, 20, 17, 18, 7 and 6–T83N–R45W (Iowa 175 interchange), Section 1–T83N–R46W, Sections 36, 26, 23, 22, 15, 10, 9, and 4–T84N–R46W, and Sections 33, 28, 29, 20, 17, 18, and 7–T85N–R46W to a point near the N $\frac{1}{4}$ Corner Section 7–T85N–R46W; thence northerly through Section 6–T85N–R46W to the Monona–Woodbury County line at a point near the N $\frac{1}{4}$ Corner Section 6–T85N–R46W, Monona County (S $\frac{1}{4}$ Corner Section 31–T86N–R46W, Woodbury County).

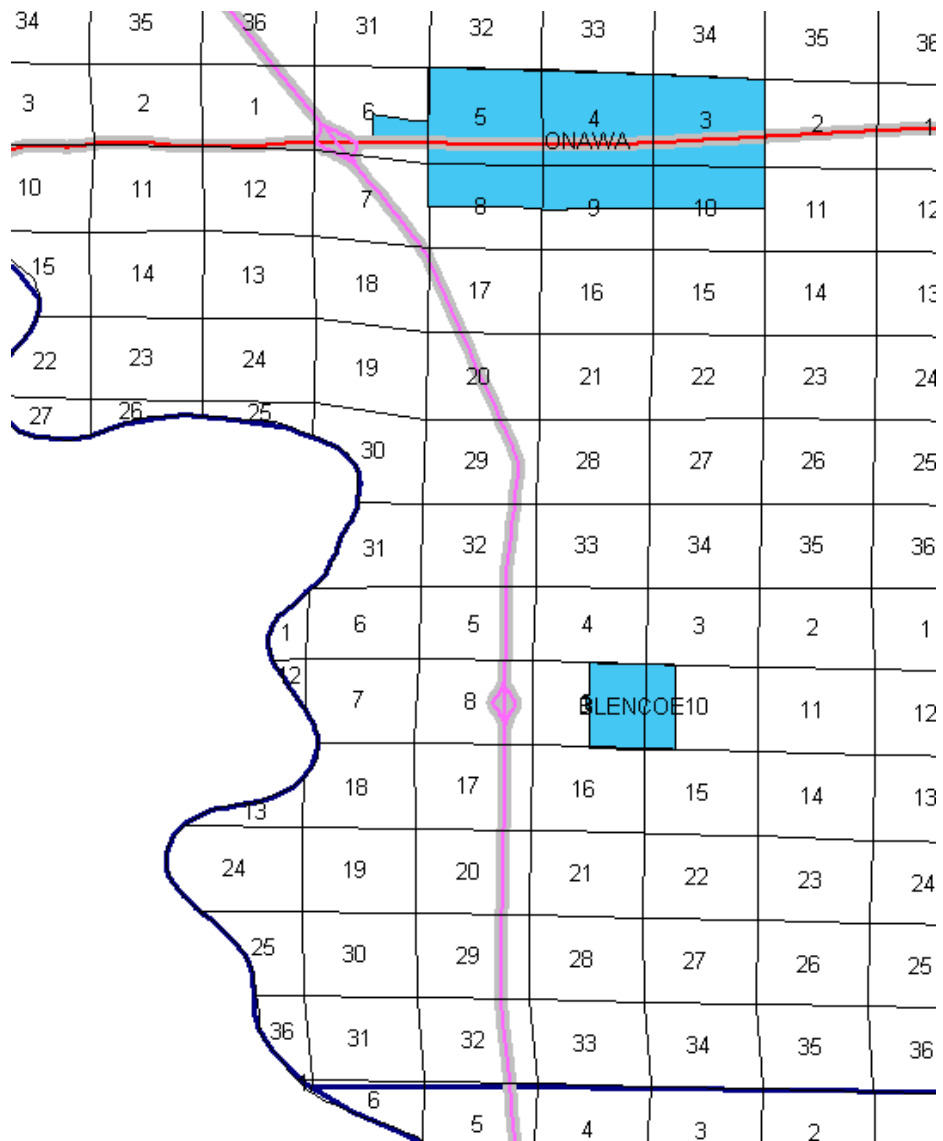

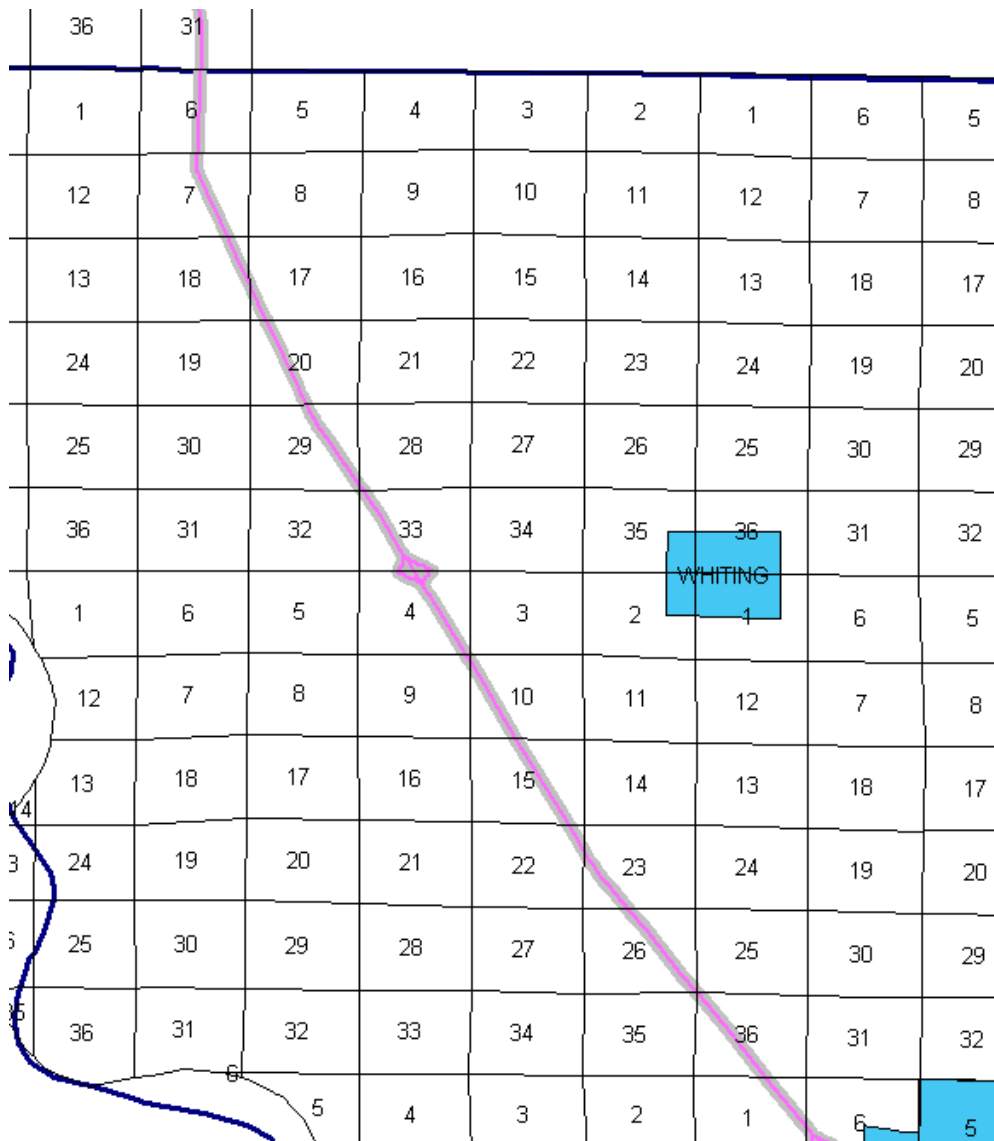

COMMISSION ORDER

DIVISION: Planning & Research

COMMISSION ORDER NUMBER: PR-79-272

SUBMITTED BY: C.I. MacGillivray

MEETING DATE: 11-2-78

DISCUSSION/BACKGROUND:

Due to a review of our Primary Interstate Road System records, Interstate 29 in Monona County should be deleted and the new description added should be officially included in the Primary Interstate Road System.

Interstate 29 begins on the Harrison–Monona County line approximately 2 miles east of the Missouri River, and travels northerly and northwesterly to the Monona–Woodbury County line approximately 6 miles east of the Missouri River.

PROPOSAL/ACTION RECOMMENDATION:

Locate Interstate 29 in Monona County as follows:

Beginning on the Monona–Harrison County line near the S $\frac{1}{4}$ Corner of the SE $\frac{1}{4}$ Section 32–T82N–R45W, Monona County (N $\frac{1}{4}$ Corner of the NE $\frac{1}{4}$ Section 5–T81N–R45W, Harrison County); thence in a northerly direction through Sections 33, 29, 20, 17, 8, and 5–T82N–R45W and Section 32–T83N–R45W to a point near the NE Corner of the NE $\frac{1}{4}$ of Section 32–T83N–R45W; thence in a northerly and northwesterly direction through Sections 29, 20, 17, 18, 7 and 6–T83N–R45W (Iowa 175 interchange); and Section 1–T83N–R46W to a point 680 feet east of the N $\frac{1}{4}$ Con. Section 1–T83N–R46W; thence continuing in a northwesterly direction through Sections 36, 26, 23, 22, 15, 10, 9, and 4–T84N–R46W to a point near the N $\frac{1}{4}$ Corner Section 4–T84N–R46W; thence continuing in a northwesterly direction through Sections 33, 28, 29, 20, 17, 18, and 7–T85N–R46W to a point approximately 185 feet east of the N $\frac{1}{4}$ Corner Section 7–T85N–R46W; thence northerly through Section 6–T85N–R46W to the Monona–Woodbury County line at a point 187 feet east of the N $\frac{1}{4}$ Corner Section 6–T85N–R46W, Monona County (S $\frac{1}{4}$ Corner Section 31–T86N–R46W, Woodbury County).

NOW, THEREFORE: Be it resolved that the Iowa Department of Transportation approve the location of Interstate 29 in Monona County, Iowa.

NOTE: To become effective upon the adoption of this resolution.

OFFICIAL DESCRIPTION CHANGE

COUNTY: Monona

ROUTE: Interstate 29

APPROVAL DATE: 12-7-66

Beginning on the Monona-Harrison County line near the SE Corner Section 32-T82N-R45W, Monona County (NE Corner Section 5-T81N-R45W, Harrison County); thence in a northerly direction through Sections 32, 29, 20, 17, 8, and 5-T82N-R45W and Sections 32 and 29-T83N-R45W to a point near the SE Corner NE $\frac{1}{4}$ Section 29-T83N-R45W; thence in a northwesterly direction through Sections 29, 20, 17, 18, 7 and 6-T83N-R45W to a point approximately 1131 feet west of the S $\frac{1}{4}$ Corner of Section 6-T83N-R45W; thence northwesterly through the SW $\frac{1}{4}$ of Section 6-T83N-R45W; and continuing northwesterly through Section 1-T83N-R46W to a point 680 feet east of the N $\frac{1}{4}$ Corner Section 1-T83N-R46W; thence continuing in a northwesterly direction through Secs. 36, 35, 26, 23, 22, 15, 10, 9, and 4-T84N-R46W to the N $\frac{1}{4}$ Corner Section 4-T84N-R46W; thence continuing in a northwesterly direction through Sections 33, 28, 29, 20, 17, 18, and 7-T85N-R46W to a point approximately 185 feet east of the N $\frac{1}{4}$ Corner Section 7-T85N-R46W; thence northerly through Section 6-T85N-R46W to the Monona-Woodbury County line at a point 187 feet east of the N $\frac{1}{4}$ Corner Section 6-T85N-R46W (S $\frac{1}{4}$ Corner Section 31-T86N-R46W Woodbury County).

REVISED: 11-2-78