

OFFICIAL DESCRIPTION CHANGE

OFFICE: Transportation Data

EFFECTIVE DATE: 07-01-2003

ENTERED BY: Stefani Wonders

ENTERED DATE: 08-28-2006

DISCUSSION/BACKGROUND:

Senate File 451 transferred Iowa 299 in its entirety, in Hardin County, to city and county jurisdiction on July 1, 2003.

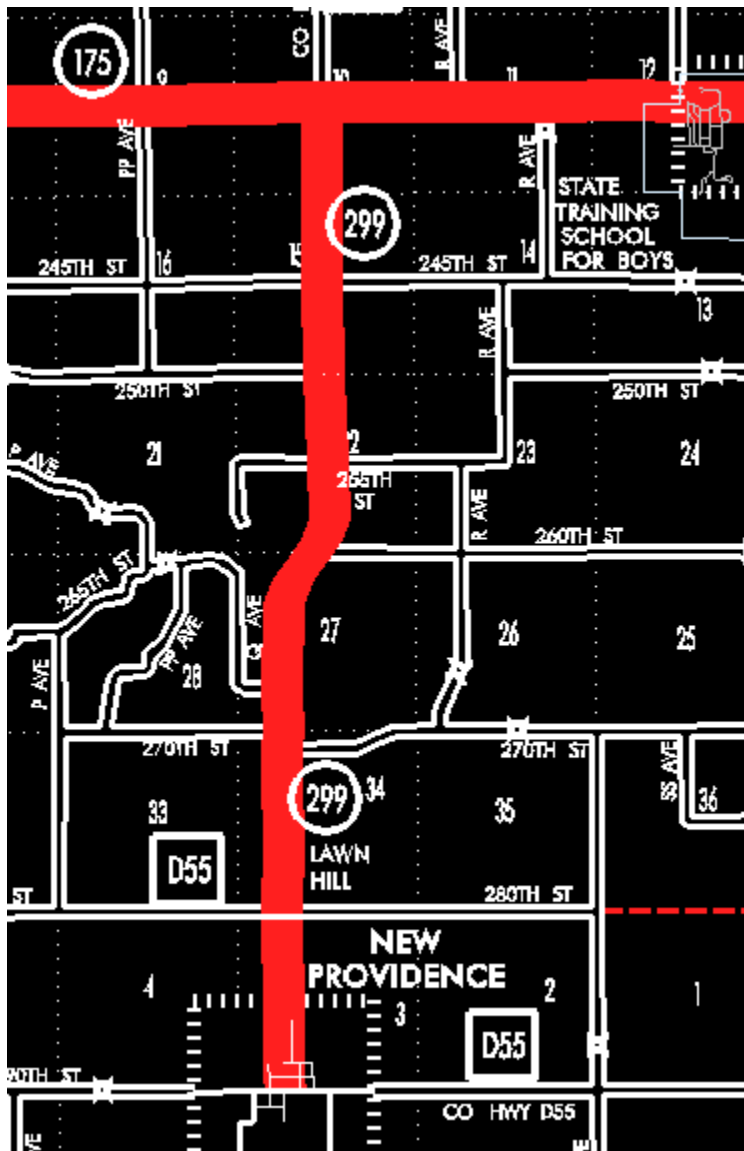

OFFICIAL DESCRIPTION CHANGE

COUNTY: Hardin

ROUTE: Iowa 299

STAFF ACTION NUMBER: S-87-731

APPROVAL DATE: 12-18-86

New Description – Iowa 299 and its extension in Hardin County described as follows:

New Providence:

Beginning on Main Street (NS) at the north line of Main Street (EW); thence north on Main Street (NS) to the north corporation line. NOTE: There are two streets in New Providence called Main.

Beginning at the north corporation line of New Providence, connecting with Main Street (NS); thence north through Section 3-T86N-R20W and Sections 34 and 27-T87N-R20W to a point approximately 1,000 feet south of the north line of Section 27-T87N-R20W; thence northeast through Sections 27 and 22-T87N-R20W to a point approximately 1,200 feet north of the S ¼ Corner Section 22-T87N-R20W; thence north following substantially the center section line of Section 22, 15, and 10-T87N-R20W to a point near the center of Section 10-T87N-R20W (junction of Iowa 175).

COMMISSION ORDER

DIVISION: Planning & Research

COMMISSION ORDER NUMBER: PR-79-272

SUBMITTED BY: C.I. MacGillivray

MEETING DATE: 11-2-78

DISCUSSION/BACKGROUND:

Due to a review of our Primary Road System records, Iowa 299 in Hardin County should be deleted and the new description added should be officially included into the Primary Road System.

Iowa 299 begins in New Providence and travels in a northerly direction terminating at the junction of Iowa 175 approximately 3 ½ miles west of Eldora, Iowa.

PROPOSAL/ACTION RECOMMENDATION:

Locate Iowa 299 and its extension in Hardin County as follows:

New Providence:

Beginning on an unnamed street at the north line of Main Street (EW); thence northerly to the north corporation line connecting with an unnamed street.

NOTE: There are two streets in New Providence called Main.

Beginning at the north corporation line of the City of New Providence, connecting with an unnamed street; thence northerly through Section 3-T86N-R20W and Sections 34 and 27-T87N-R20W to a point approximately 1000 feet south of the north line of Section 27-T87N-R20W; thence northeasterly through Sections 27 and 22-T87N-R20W to a point approximately 1200 feet north of the S ¼ Corner Section 22-T87N-R20W; thence northerly following substantially the center section line of Section 22, 15, and 10-T87N-R20W to a point near the center of Section 10-T87N-R20W (junction of Iowa 175).

NOW, THEREFORE: Be it resolved that the Iowa Department of Transportation approve the location of Iowa 299 in Hardin County, Iowa.

NOTE: To become effective upon adoption of this resolution.

REVISED: 12-18-86

OFFICIAL DESCRIPTION CHANGE

COUNTY: Hardin

CITY OF: New Providence

ROUTE: Iowa 299

APPROVAL DATE: 11-23-66

Beginning on Main Street (NS) at the north line of Main Street (EW); thence northerly on Main Street (NS) to the north corporation line.

NOTE: There are two streets in New Providence called Main.

REVISED: 11-2-78

OFFICIAL DESCRIPTION CHANGE

COUNTY: Hardin

ROUTE: Iowa 299

APPROVAL DATE: 5-29-63

Beginning on the north corporation line of the Town of New Providence connecting with Main Street; thence north through Section 3-T86N-R20W and Sections 34 and 27-T87N-R20W to a point approximately 1,000 feet south of the north line of Section 27-T87N-R20W; thence northeasterly across Sections 27 and 22-T87N-R20W to a point about 1,200 feet north of the S $\frac{1}{4}$ Corner of Section 22-T87N-R20W; thence north following substantially the quarter section line to a point near the center of Section 10-T87N-R20W (junction Iowa 175).

REVISED: 11-2-78