

**OFFICIAL DESCRIPTION CHANGE****OFFICE:** Transportation Data**EFFECTIVE DATE:** 08-08-2007**ENTERED BY:** Darlene Bovee**ENTERED DATE:** 11-01-2007

Transfer of jurisdiction agreement number 2003-TJ-003, between Lee County and the Iowa Department of Transportation, transferred that portion of Unsigned Iowa 460 from the Iowa-Missouri State line at a point approximately 1600 feet south and 100 feet east of the NW Corner Section 4-T65N-R6W; thence northerly through said Section 4 to a point near the NW Corner Section 4-T65N-R6W; thence northerly following substantially the section line of Section 33-T66N-R6W to a point approximately 160 feet north of the SW Corner said Section 33-T66N-R6W to county jurisdiction on August 8, 2007.

Transfer of jurisdiction agreement number 2003-TJ-003, between Lee County and the Iowa Department of Transportation, transferred that portion of Unsigned Iowa 460 from Argyle Road (approximately 3490 feet south of the NW Corner Section 16-T66-R6W; thence northerly following substantially the west line of Sections 16, 9, and 4-T66N-R6W to 285 Street (approximately 296 feet east and 970 feet north of the SW Corner of said Section 4) to county jurisdiction on August 8, 2007.

Transfer of jurisdiction agreement number 2003-TJ-003, between Lee County and the Iowa Department of Transportation, transferred that portion of Unsigned Iowa 460 from 255 Street (approximately 2658 feet south of the NW Corner Section 21-T67N-R6W); thence northerly following substantially the west section line of Sections 21, 16 and 9-T67N-R6W to the junction of US 218 (approximately 779 feet north and 308 feet east of the SW Corner of said Section 9); thence northeasterly to approximately 1738 feet north of the SW Corner of said Section 9; thence northerly following substantially the west section line of Sections 9 and 4-T67N-R6W to the south corporation line of Donnellson (approximately

1300 feet south of the NW Corner of said Section 4) connecting with South Main Street to county jurisdiction on August 8, 2007.

Transfer of jurisdiction agreement 2002-TJ-017 and 2002-TJ-017A, between the City of Donnellson and the Iowa Department of Transportation, transferred that portion of Unsigned Iowa 460 from the south corporation line connecting with South Main Street; thence northerly to the north corporation line (approximately the NW Corner of Section 33-T68N-R6W) to city jurisdiction on August 8, 2007.

Transfer of jurisdiction agreement 2003-TJ-003, between Lee County and the Iowa Department of Transportation, transferred that portion of Unsigned Iowa 460 from the north corporation line connecting with North Main Street; thence northerly following substantially the west section line of Section 28-T68N-R6W to 200 Street (NW Corner Section 28-T68N-R6W) to county jurisdiction on August 8, 2007.

Transfer of jurisdiction agreement 2003-TJ-003, between Lee County and the Iowa Department of Transportation, transferred that portion of Unsigned Iowa 460 from a point approximately 1680 feet north of the SW Corner of Section 33-T69N-R6W; thence northerly following substantially the west section line of said Section 33 to a point approximately 3600 feet north of the SW Corner of said Section 33-T69N-R6W to county jurisdiction on August 8, 2007.

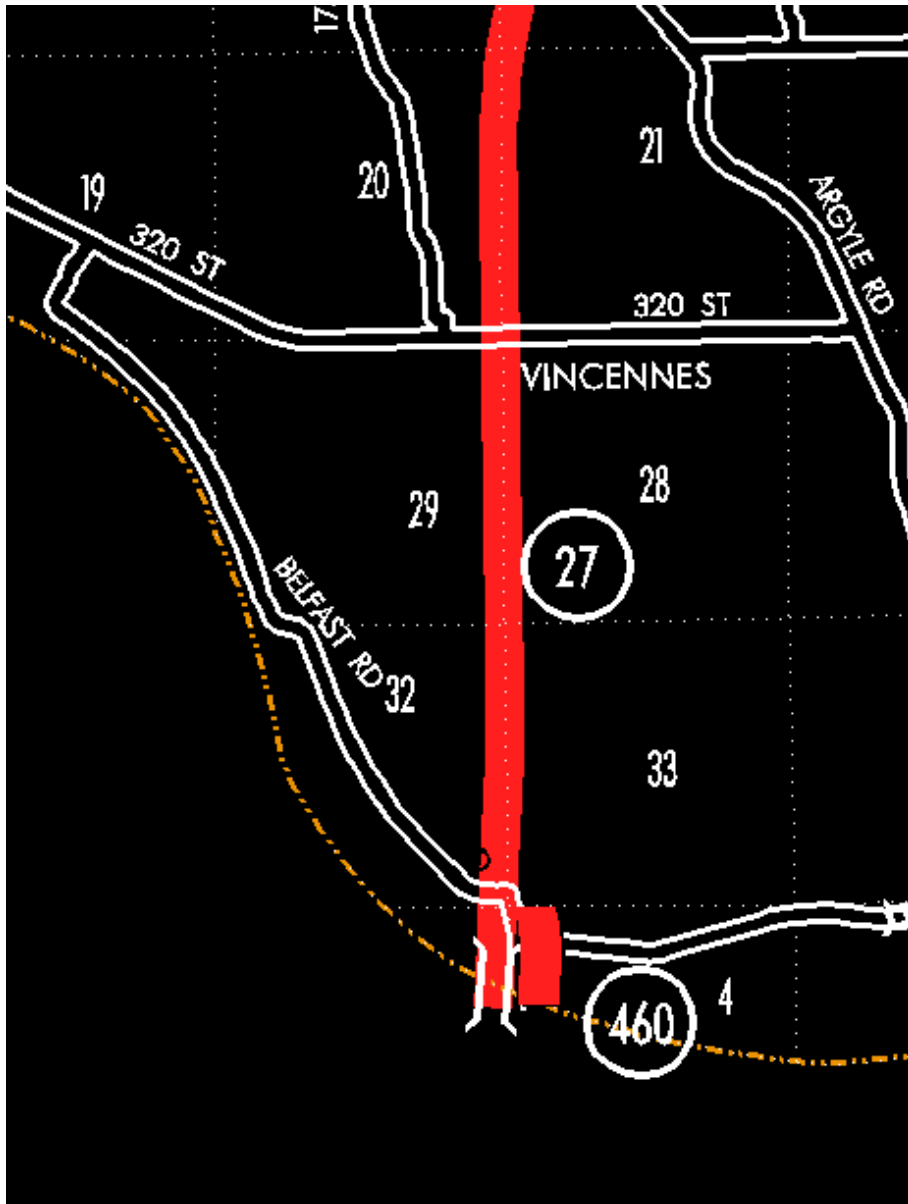



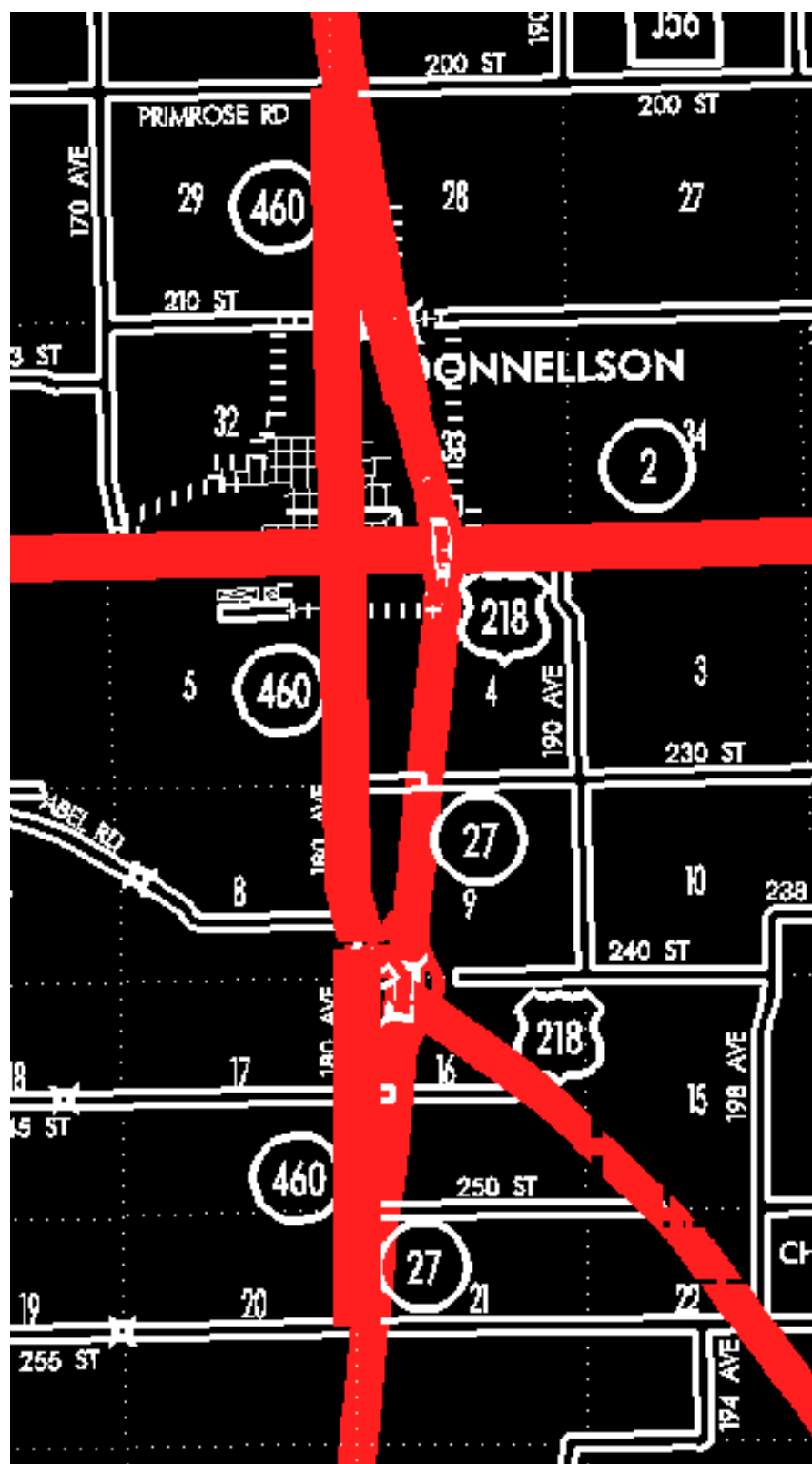



#### OFFICIAL DESCRIPTION CHANGE

OFFICE: Transportation Data

EFFECTIVE DATE: 03-15-2005

ENTERED BY: Stefani Wonders

ENTERED DATE: 09-06-2006

#### DISCUSSION/BACKGROUND:

Due to the relocation of portions of Iowa 27 in Lee County, the old portions were re-designated to Unsigned Iowa 460.

## **PROPOSAL/ACTION RECOMMENDATION:**

It is recommended that Unsigned Iowa 460 in Lee County, as described, be added to the Primary Road System.

New Description – Unsigned Iowa 460 in Lee County described as follows:

Beginning at Argyle Road (approximately 3490 feet south of the NW Corner Section 16–T66N–R6W); thence northerly following substantially the west section line of Sections 16, 9, and 4–T66N–R6W to 285 Street (approximately 296 feet east and 970 feet north of the SW Corner of said Section 4).

Beginning again at 255 Street (approximately 2658 feet south of the NW Corner Section 21–T67N–R6W); thence northerly following substantially the west section line of Sections 21, 16, and 9–T67N–R6W to the junction of US 218 (approximately 779 feet north and 308 feet east of the SW Corner of said Section 9); thence northeasterly to approximately 1738 feet north of the SW Corner of said Section 9; thence northerly following substantially the west section line of Sections 9 and 4–T67N–R6W to the south corporation line of Donnellson (approximately 1300 feet south of the NW Corner of said Section 4) connecting with South Main Street.

Donnellson:

Beginning on the south corporation line connecting with South Main Street; thence northerly on South Main Street to the north corporation line (approximately the NW Corner of Section 33–T68N–R6W).

Beginning again on the north corporation line of Donnellson connecting with South Main Street; thence northerly following substantially the west section line of Section 28–T68N–R6W to 200 Street (NW Corner of said Section 28).

